



## GRAND SLAM 950 ELECTRIC ANCHOR & STERN LIGHT



Complete your electric-mount arsenal with the new Grand Slam 950 Electric Anchor & Stern Light! With the simple push of a button, boaters can safely adjust the position of their Anchor & Stern Light from the comfort of the helm. Ideal for powered vessels 39' and under (12-meters and under), the GS-950 is certified for USCG-required 2 nautical miles. The GS-950 is a fully electric unit with hidden wires inside the hardtop. This mount easily installs to the surface of the hardtop and fits all top thicknesses. The GS-950 lights run on 12 volts and consists of four 3-watt LED Cree chips driven by two Mean Well drivers.

### GS-950 FEATURES & BENEFITS

- Machined / Anodized aluminum body with a Light-brushed finish
- Certified for USCG-required 2-nm
- Includes tube, light and 10" lead for 12-volt DC power supply for light function
- Threaded shaft for consistent lift and descent
- Delrin bearings for smooth operation
- Features removable set pin for manual adjustment
- Mounts to all hardtops
- Reliable long-life LEDs
- 6-Watt Stern Light and 12-watt Anchor
- Low-draw, 0.6 amps per light
- Low-voltage 12-24VDC
- Made in the USA
- 1-year limited warranty

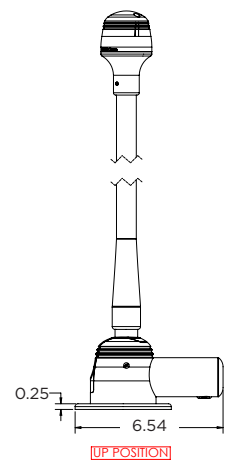
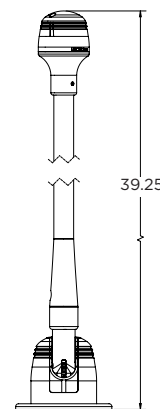
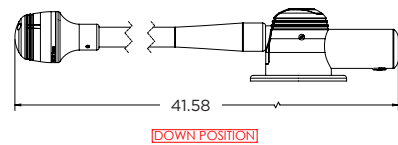
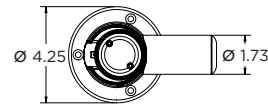

PART NUMBER	DESCRIPTION	WEIGHT	UNIT	CoO	STD. PK.	UPC
GS-950	Grand Slam 950 Anchor & Stern Light	3.5 lbs	Each	USA	2	631003089992