

Battery Switch Operation Diagrams

M-Series Battery Switches

300 Ampere continuous rating for outboards and small gasoline or diesel engines

E-Series Battery Switches

350 Ampere continuous rating for inboard gasoline or diesel engines

Single Circuit ON-OFF

Switches a single battery to a single load group

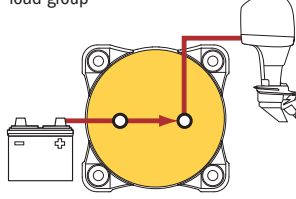

HD-Series Battery Switches

Up to 600 Ampere continuous rating for large diesel engines

Single Circuit ON-OFF

Switches a single battery to a single load group

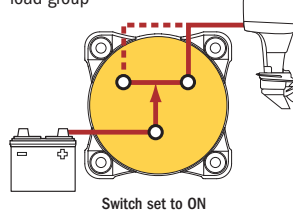

E-Series Battery Switches

350 Ampere continuous rating for inboard gasoline or diesel engines

Selector 3 Position

Switches isolated battery banks to all loads

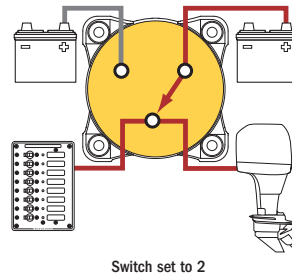
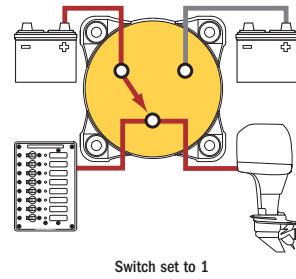

M-Series Battery Switches

300 Ampere continuous rating for outboards and small gasoline or diesel engines

E-Series Battery Switches

350 Ampere continuous rating for inboard gasoline or diesel engines

HD-Series Battery Switches

Up to 600 Ampere continuous rating for large diesel engines

Selector 4 Position

Switches isolated battery banks to all loads or combines battery banks to all loads

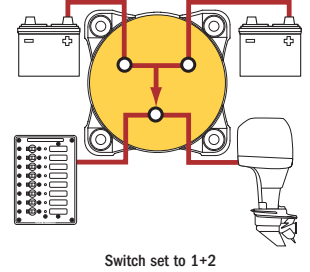
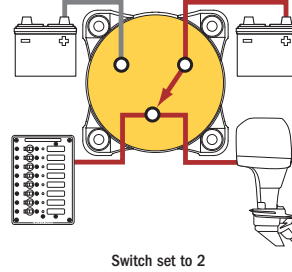
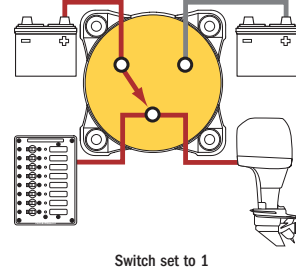

M-Series Battery Switches

300 Ampere continuous rating for outboards and small gasoline or diesel engines

E-Series Battery Switches

350 Ampere continuous rating for inboard gasoline or diesel engines

Dual Circuit™

Simultaneously switches two isolated battery banks

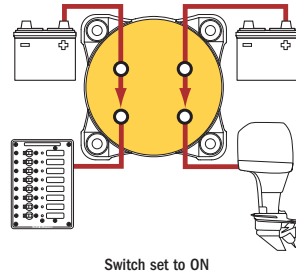

M-Series Battery Switches

300 Ampere continuous rating for outboards and small gasoline or diesel engines

E-Series Battery Switches

350 Ampere continuous rating for inboard gasoline or diesel engines

Dual Circuit Plus™

Simultaneously switches two isolated battery banks or combines battery banks to all loads (with combine function)

